

Angles with the meridian	Perches
N 21 E	38
N 78 E	17
N 43 W	23
S 82 W	14
N 18 W	19
S 40 W	12
S 7 E	14
S 68 W	16
SOUTH	18
WEST	16
N 49 W	40
N 20 E	16
N 86 W	10
N 70 W	40
N 81 W	58
S 71 W	18
N 50 W	18
S 60 W	17
N 50 W	15

The Courses
up Crum Creek

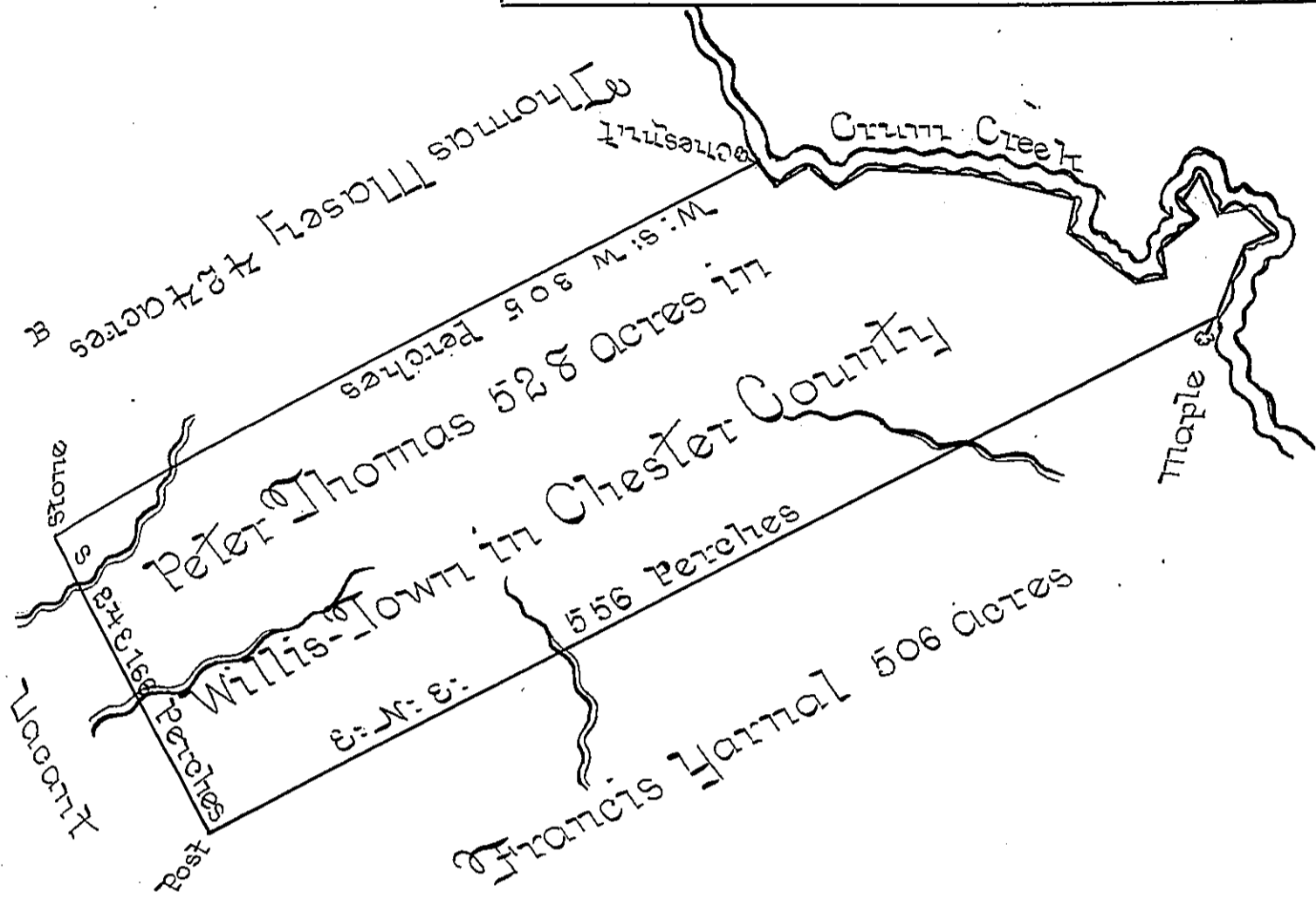

Assurveyed ye 14th of the first month 1703 By Virtue
of a Warrant from ye Commissioners of Property
to me directed Dated ye 28th of 10br 1702

Revised in the Genl Surveyers office
The 20th of the 3d month 1703
Isaac Taylor

IN TESTIMONY that the above is a copy of the original remaining on file in the
Department of Internal Affairs of Pennsylvania, made con-
formably to an Act of Assembly approved the 16th day of
February, 1833, I have hereunto set my Hand and caused
the Seal of said Department to be affixed at Harrisburg, this

~~seventh~~ day of ~~September~~ 1897

James W. Patton
Secretary of Internal Affairs.